

Studio Clam Press

How to change a Digital Heat Controller

Replacement/Removal of Digital Heat Controller

N.B. Before undertaking any work, switch off the power supply to the machine and unplug the machine from the electricity supply

1. Remove six screws from Rear Cover (pic 1)
2. Remove Rear Cover from Instrument Cover
3. Remove wires connected to Digital Heat Controller (pic 2), taking note of the connections for future reference when reinstalling new Controller
4. Lift up tabs (on Both sides) of Retaining Bracket and push Digital Heat Controller out through Instrument Cover and Facia (pic 3), taking note of their position for future reference when reinstalling new Digital Heat Controller

Re-installation of replacement Digital Heat Controller

1. Installation is a reversal of removal



pic 1

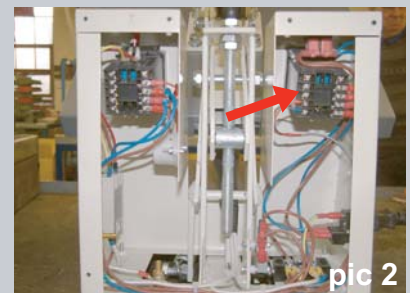

pic 2

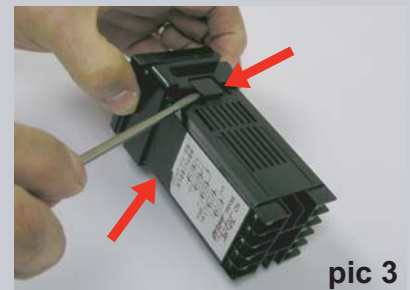

pic 3